

"Keep it dry, keep it safe"



Marketing Office: Statesman House, Office No-805, 8th Floor, Avanta Business Centre,
Barakhamba Road, Connaught Place, Delhi-110001 (India)
Registered Office: Sir Sobha Singh Building, 2nd Floor, 5286 Shradhanand Marg,
Ajmeri Gate, Delhi-110006 (India)
Tel: 011-66308888 | 23213234 | Email: info@dbsbp.com
Web: www.dbsbp.com



"What You Build Brick By Brick Can
Get Spoiled Drop By Drop"



PRODUCTS

- EPDM Membrane
- TPO Membrane
- HDPE Membrane
- APP Membrane
- PU Coating
- Geotextile
- Bunker Mat (Golf Courses)
- Microsilica
- Drainage Board
- Insulation (XPS, Polyiso)
- Spray Applied Coating



DBS BUILDING PRODUCTS

DBS Building Products is confident of its future and proud of its past.

DBS Building Products was incorporated in 2010. Within a short span of time, The company has successfully provided waterproofing & Insulation solutions to more than 200 Iconic Projects all across India. Our company is responsible for introducing the latest waterproofing and insulation technology in India from the companies around the world.

Our company specializes in providing following solutions to the Building Industries:

- 👉 *Bridge Deck Waterproofing*
- 👉 *Golf Course Lake Lining and Bunker Mat*
- 👉 *Basement Waterproofing*
- 👉 *Airports Roof (Waterproofing + Insulation)*
- 👉 *Metal Deck Structures (Waterproofing + Insulation)*
- 👉 *Podium Waterproofing (Waterproofing + Landscape)*
- 👉 *Concrete Roof Waterproofing (Waterproofing + Insulation)*
- 👉 *Green Roofs/Terrace Gardens*



Golf Course Lake Lining



Airport Decks



Basement Waterproofing

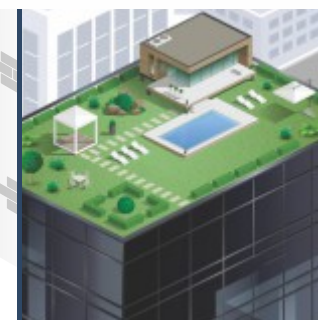

*Green Roofs/
Terrace gardens*

Not always visible, but always present: because the usage of waterproofing in buildings is manifold, so are the solutions that DBS Building Products offers. No matter if it is an commercial, an industrial building, a concrete structure, a historic building, a lining application, a golf course or a bridge deck: We offer a wide range of effective products and systems which guarantee a safe waterproofing.

"Keep it dry, keep it safe"

TECHNICAL ADVICE

We want our partners to benefit from our technical know-how and experience. The distribution of our products via technical consultants ensures that our customers receive the support they need in order to apply our products effectively and properly. That is why our customers worldwide can rely on our advice wherever it is needed:

Personally.....directly on the construction site..... and on the phone.

Individual waterproofing solutions: our flexibility is your advantage.

Sometimes waterproofing problems cannot be solved by existing products or methods but need an individual solution. Together with our customers we analyze each situation and then develop a customized solution for their specific problem.

Waterproofing is the most cost effective way to maintain the value of a building

Why quality? As a general rule, more than 80% of damages to apartment buildings are due to the effects of water. Typically, for less than 5% of the construction cost quality waterproofing can be achieved.

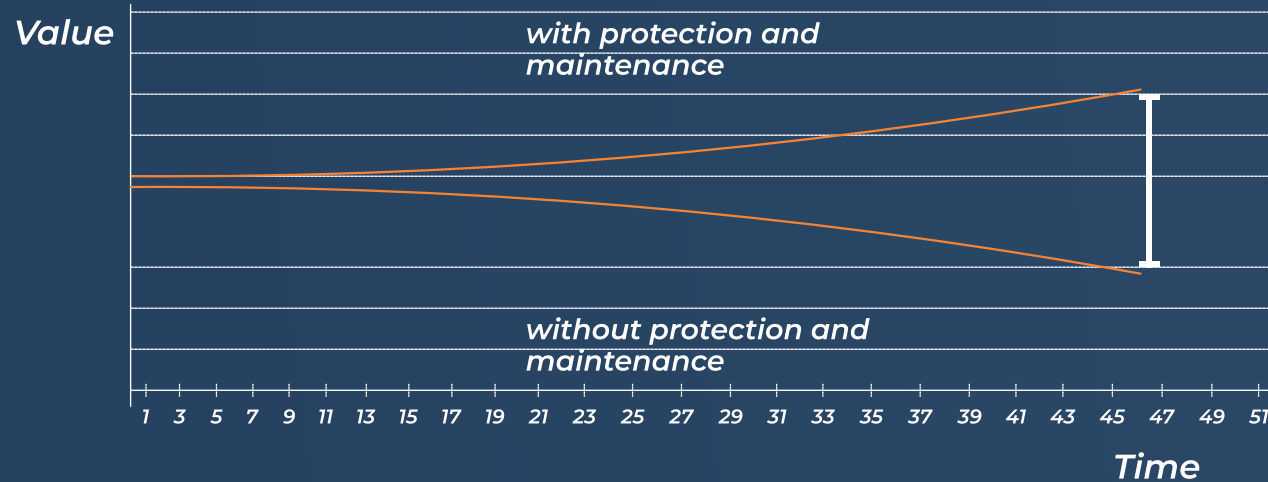

"Nobody Covers You Better"

What is the best waterproofing solution for specific situation? DBS Building Products gives great importance to training in order to get the greatest value for our customers. Architect & Contractors and other interested persons are frequently trained to ensure that they possess in-depth theoretical and practical knowledge about our products and about waterproofing technology. Technical training is carried out at the training centre in India as well as Brussels (Belgium).

Good waterproofing solutions require analysis of the construction, a professional concept, and the right products.

Technical Training at DBS Building Products...





and in practice



Our waterproofing systems protect and preserve valuable buildings and structures worldwide.

DBS Building Products offers a comprehensive range of material in order to provide optimal solutions for the waterproofing of new buildings and restoration of old buildings.

Our high quality and long lasting waterproofing systems sustainably increase the life cycle of buildings. By preventing moisture damage, expensive repairs can be avoided and energy consumption can be reduced permanently.

Our goal is the satisfaction of our customers through exemplary service, our professionalism and competence.

Always and Everywhere

DBSBP PRESTIGIOUS CLIENTS



DBSBP PRESTIGIOUS CLIENTS



DBSBP PRESTIGIOUS ARCHITECTS

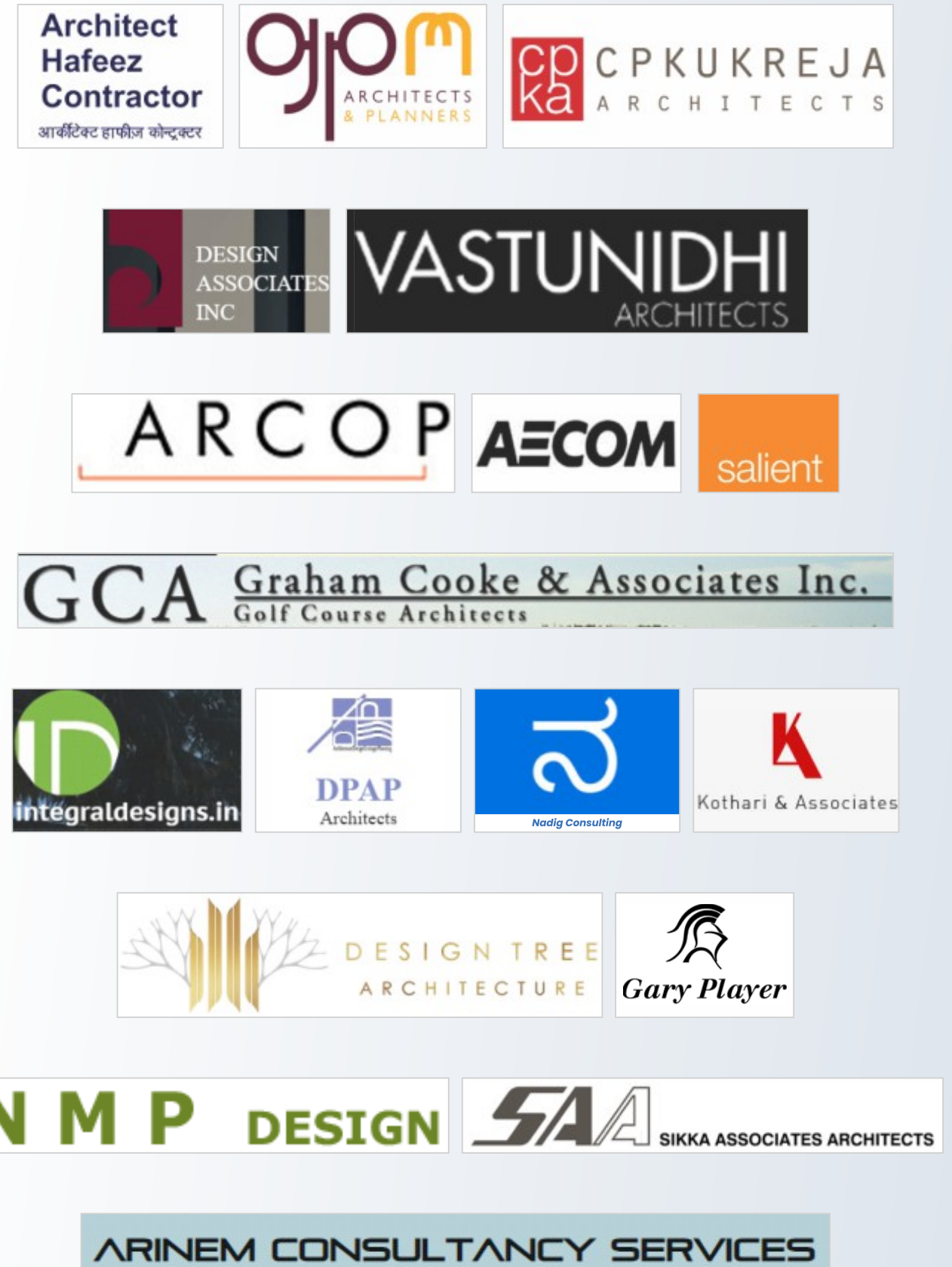

POND LINING REFERENCES



The Lagoon By Avinash Group - Naya Raipur, Chhattisgarh



DLF Golf & Country Club - Gurgaon



Ambience Cairtriona Green - Gurgaon



Purana Qila Lake - Delhi



Jaypee Greens Golf Course - Greater Noida

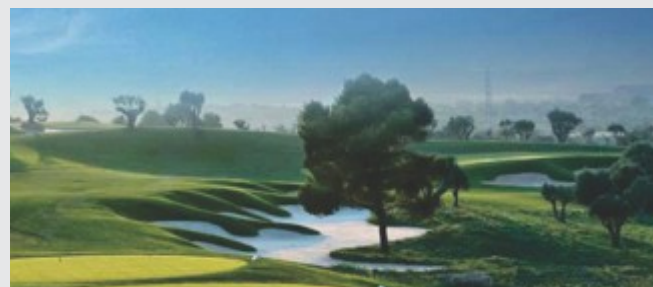

The Imperial Golf Course by Silverglades - Ludhiana

POND LINING REFERENCES



Prestige Golf Shire - Bangalore



HUDA Panchkula Golf Club - Haryana



Glade One Golf Club by Safal - Sanand, Gujarat



CIDCO Kharghar Golf Course - Mumbai



IIT Bhilai - Raipur - Chhattisgarh

POND LINING REFERENCES



Rambagh Golf Club - Jaipur, Rajasthan



Aarone Countrywalk Oasis Township - Indore (M.P.)



Jaquar Corporate Office - Manesar, Haryana



Bansal Wire Manufacturing Unit - Dadri (U.P.)

ROOFING WATERPROOFING REFERENCE



IICC Yashobhoomi - Dwarka



ITPO - Pragati Maidan



British High Commission - Delhi



Defence Office Complex - KG Marg, Delhi

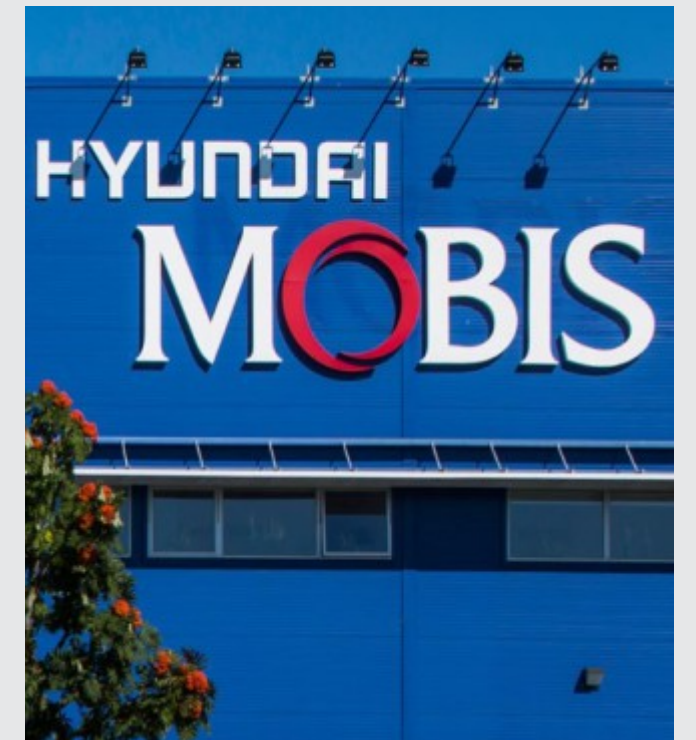

Hyundai Mobis Plant - Chennai



Manekshaw Auditorium - Delhi

ROOFING WATERPROOFING REFERENCE



ONGC Head Office - Vasantkunj, Delhi



ESIC Medical - Hyderabad



Kellogg's Factory - Taloja



Kia Motor - Telangana, Andhra Pradesh



Bhagwan Mahavir Hospital - Delhi

BASEMENT REFERENCES



India Gate Central Vista Avenue - Delhi



RBI Data Centre - Bhubaneswar, Odisha



UID Data Center (Aadhar) - Bangalore



Dr. Bhimrao Ambedkar Multispeciality Hospital - Noida

BASEMENT REFERENCES



ONGC Office - Mumbai



**Pathways School
- Gurgaon**



**Bhiwani Medical College
- Haryana**



**Indira Gandhi Eye Hospital
- Gurugram, Haryana**



**Delhi University Rugby Stadium
- Delhi**

PODIUM REFERENCES



DLF Camelia - Gurugram



**Paul George Global School
Alaknanda, New Delhi**

**St. Paul George School
- Alaknanda, Delhi**



**Noida Shilp Haat & Bunker Bhawan
- Sector 33A, Noida**



**ESIC Medical College & Hospital -
Faridabad, Haryana**



**Multi-Level Car Parking Sector 18 -
Noida, Uttar Pradesh**

PODIUM REFERENCES



Lal Bahadur Shastri Hospital



The Oberoi Office Tower, DLF Cyber City - Gurgaon



*The Shahi Exports Pvt Ltd.
- Noida, Uttar Pradesh*



*U.P. Secretariat
- Lucknow*